

Marley Brown Plain tiles fixed to 38 x 19mm battens set to 100mm gauge, fixed to 100 x 47mm rafters at 400mm ctrs. 170 x 47mm ceiling joists to be connected with "toothed connector" and 12mmØ bolts. Tyvek Supro breather membrane fixed between battens and rafters. Dpc to be laid over Tyvek at tile/fascia junction to protect Tyvek. Gypglass 170mm Gypglass insulation between joists and 120mm over joists. 12.5mm Duplex plasterboard fixed to the u/s of joists with skim coat plaster finish

Valley gutter to be Code 5 lead on WBP 18mm ply 250mm wide min. either side of centre of valley, with 55mm step.

Valley gutter code 4 lead supported on 12mm WBP plywood fixed to rafters.

Notes:-  
 Wall Construction  
 103mm LBC Heathers or similar to match existing  
 75mm cavity with 50mm Celotex CW4000 insulation and 25mm air gap.  
 100mm Thermalite Turbo blocks with 15mm plaster

Wall ties 900mm max. horizontal centres and 450mm vertically. Junction of new and ex. brickwork to be Stronghold S.S. connectors to be weathersealed with pre-compressed sealing strip or polymer-based sealant applied behind the connectors.

New dpcs and dpms to be tied into existing dpms.

Existing foundation, walls and lintols supporting additional loads to be exposed for assessment and upgraded if found inadequate.

Lateral restraint to walls provided by Catnic 38 x 5mm straps at 2000mm ctrs and 38 x 5mm wall plate straps at 2000mm ctrs.

Rafters and ceiling joists to be bolted together with 12mmØ bolts and 50mm toothed plate connectors. Roof timbers to be tanalised as prevention of longhorn beetle infestation.

Rockwool Rockclose insulated dpms at window and door reveals. All external windows and door frames to be sealed internally and externally with mastic sealant. Glass to windows to be double glazed 16mm min. air gap and have a soft low E coating. (U value 1.4 W/m²K)

All windows to habitable rooms to have min. clear opening of 450mm wide x 750mm deep not more than 1100mm ffl. and not less than 800mm ffl.

All new electrical work to be designed, installed inspected and tested in accordance with BS 7671 (I.E.E. Wiring Regulations 17th. edition) The work to be undertaken by an installer registered under a suitable electrical self-certification scheme, or alternatively by a suitable qualified person, with certificate of compliance produced by that person to Building Control on completion of the works. Socket outlets to be a minimum of 450mm above finished floor level. Light switches to be a minimum of 1200mm above finished floor level.

Low energy light fittings to be fitted to all rooms in extension to comply with part 11b of the building regs. lamps having a luminacy efficacy of 40 lumens per circuit-watt. compact fluorescent fittings or similar.

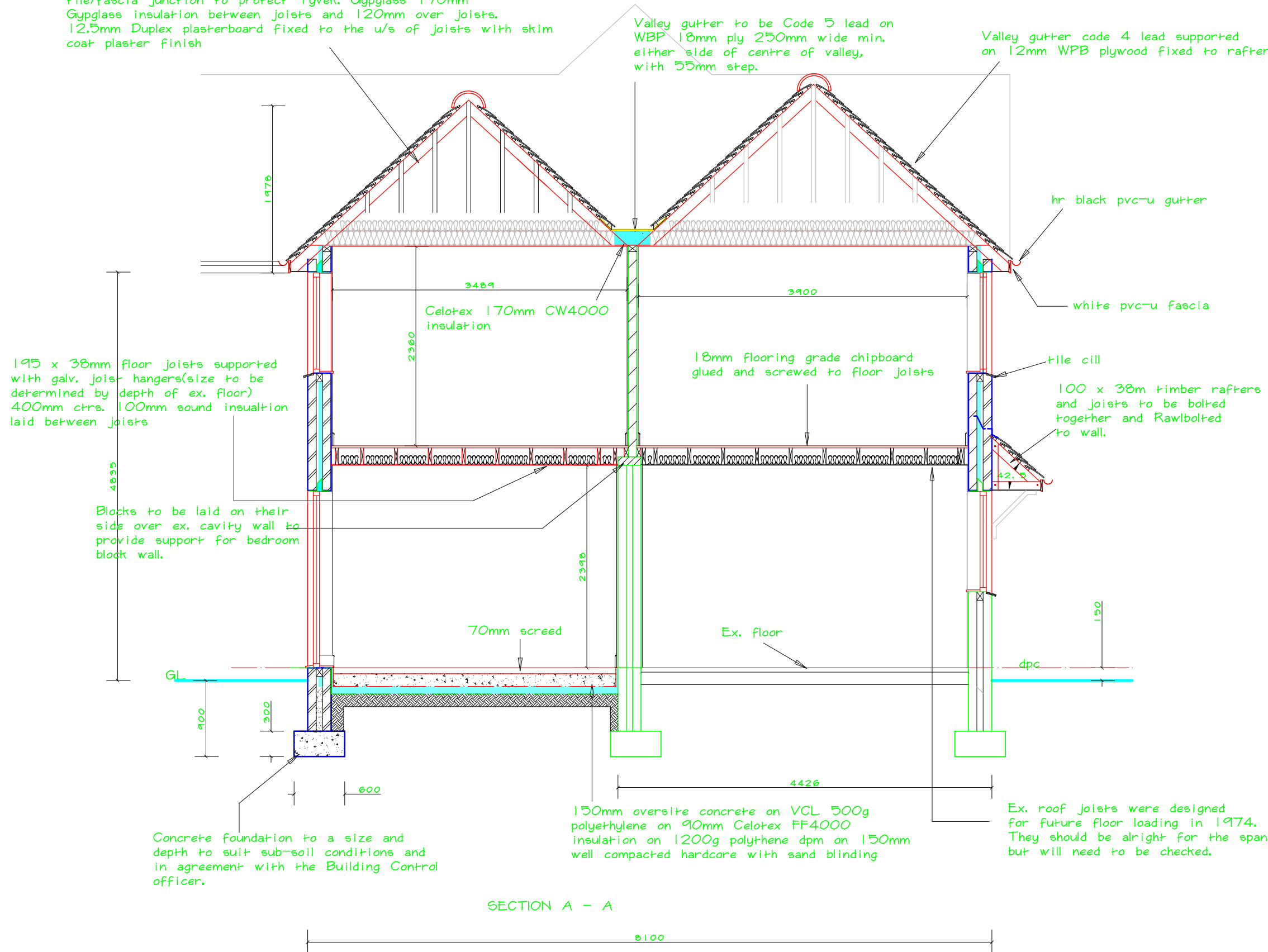

TWO STOREY AND FIRST FLOOR SIDE EXTENSION TO NO.10 SIMONS WALK, ENGLEFIELD GREEN, SURREY TW20 ODQ FOR MR JFP DICKENSON

Date: 12.04.2011  
 Scale 1:50, A3 paper size  
 Drawing No. JFPA/5